



The \$5 million challenge

John A. and Susan Sobrato make a historic challenge grant to the VMC Foundation





“Failure was not an option.”

I was told we would fail. Repeatedly. Even by my own staff. Yikes!

Facing a state-mandated requirement to make Valley Medical Center earthquake safe (or risk closure), the VMC Foundation was asked to do something we had never done before – figure out how to get the voters of Santa Clara County to approve \$840 million in spending for a new hospital.

The odds were long. A tax measure would require 2/3rds of the vote.

But the consequences of failure were potentially catastrophic. If VMC closed, Silicon Valley’s entire healthcare system (public and private) would be thrown into chaos.

It’s cliché to say – but failure was not an option.

An early poll told us that we would probably lose, with one caveat – when people actually took the time to learn about the essential role VMC plays in this community, their opinion flipped overwhelmingly to one of support. It was a ray of hope. If we could only tell the story of VMC to everyone, we’d win. Maybe.

What happened next was a whirlwind of activity; building a coalition of community, labor, small business and healthcare leaders to raise over \$1 million and mount an aggressive campaign. The Board of Supervisors

voted unanimously to place Measure A on the November 2008 general election ballot.

And on election night, the response was overwhelming. Measure A won with 78% of the vote, even besting President Obama for most votes from Santa Clara County residents.

It was a staggering victory, and one in which I was honored to play a part.

Construction on a new, state-of-the-art hospital building began almost at once. The 370,000 square foot facility will help VMC continue to serve this community for generations to come, just as we have done since 1876.

But Measure A was only the beginning, for while these dollars will pay for the construction of the building, additional resources are needed to outfit the facility with life saving equipment and essential medical technology.

So, once again, the VMC Foundation is taking on a big challenge – to raise \$10 million in support of the new VMC. A new campaign has been born. Failure? Yeah – not an option.

This publication is about that campaign, and the historic challenge grant offered by John A. and Susan Sobrato. If we can raise \$5 million from the community by 2014, they’ll match it, dollar-for-dollar. They believe in the mission of VMC – of providing quality healthcare to all regardless of ability to pay.

As you’ll read in these pages, VMC is poised to open one of the most advanced medical centers in the United States. But only with your help. Learn how you can contribute by visiting www.vmcfoundation.org.

- Chris Wilder, Executive Director, Valley Medical Center Foundation

Therma and VMC working towards the future.

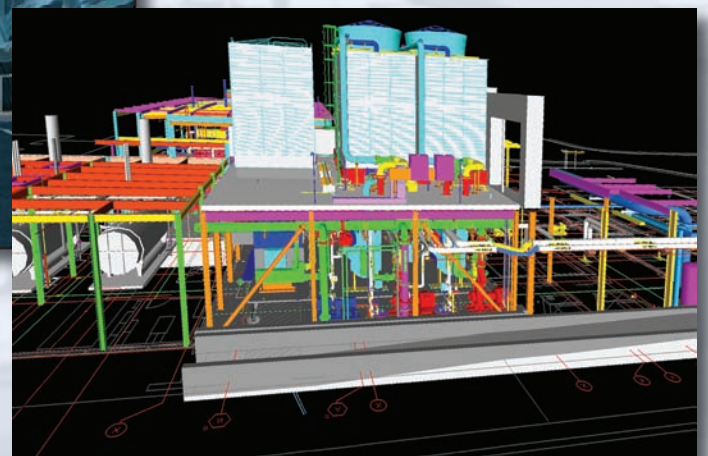

The Valley Medical Center Central Plant project includes upgrading the existing energy plant by adding the following equipment:

- (2) additional 25 thousand pounds per hour steam boilers for a total plant capacity of 100 thousand pounds per hour of steam.
- (2) new 12 hundred ton chillers for a total plant cooling capacity of 6 thousand tons.
- (2) new cooling towers, new and replacement chilled water and condenser water pumps, all new steam boiler ancillary equipment, and complete upgrade of the diesel fuel oil system for the emergency generator and steam boiler back-up operations.



A Message from Focus Business Bank

Focus Business Bank is privileged to work with the finest non-profit organizations including the Valley Medical Center Foundation, which raises funds and awareness of the services within the Santa Clara Valley Health & Hospital System including Valley Medical Center. Through the outstanding efforts of the Foundation's Board of Directors and staff headed by Executive Director Chris Wilder, significant support is generated for Valley Medical Center and its mission of providing high-quality treatment for emergency medical care, trauma, burns and rehabilitation from severe injuries – in some cases the only such treatment in the region. Focus Business Bank is

proud to be a member of the Valley Medical Center Foundation team.

Focus Business Bank is committed to working with the public benefit community of Santa Clara County. Our broad experience working with not-for profit organizations across all service sectors has enabled us to develop banking solutions which add value to our relationships. We recognize the critical role that our non-profits play and look forward to working closely with them in the future.

- Richard L. Conniff, President & CEO, Focus Business Bank

The VMC Foundation Board of Directors

Front (left to right): Susanne Wilson, Kathleen King, Cheryl Dewey, Jean Meddaugh, Elaine Elkin, Winnie H. Wan, Ph.D, Antonia Charles, M.D..

Back (left to right): Thomas Bush, M.D., John A. Sobrato, Norman Kline, Kerry Langstaff, E. Christopher Wilder, Leah Toeniskoetter (fmr.) Balaji Govindaswami, M.D., M.P.H., Louis Frankel, Robert Violante, M.D., Robin Roche, J. Timothy Maximoff.

Not pictured: Judy Cosgrove, Ralph Dickman, Ysabel Duron, Paul Estess, Joseph Parisi, Greg Sellers, Ron Sidell.

On the cover: Susan Sobrato, John A. Sobrato, E. Christopher Wilder, John M. Sobrato, CEO of The Sobrato Organization, Lisa Sobrato Sonsini, President, The Sobrato Family Foundation. Photo by Vicki Thompson.



Turner Construction is honored to be the General Contractor on Santa Clara Valley Medical Center's new Replacement Bed Building. This 370,000 SF inpatient building will be the new home to the Intensive Care, Rehabilitation and Transitional Acute Care Nursing Units.

Santa Clara Valley Medical Center is using Building Information Management (BIM) for all aspects of the work including a structural model, MEPP coordination, exterior wall systems, etc.

SUSTAINABLE FEATURES:

- Leadership in Energy and Environmental Design (LEED) Gold certification
- Reduce energy use of over 43% compared to California Title 24 requirements
- Enhanced exterior wall system to minimize heat loss and gain with sunshades
- Low-VOC (volatile organic compounds) building materials to reduce indoor air pollution
- Recycling of high percentage of construction waste



Thank You To Everyone at Santa Clara Valley Medical Center for Your Tireless Commitment to the Well Being of our Community!



A family legacy

In Silicon Valley, nobody does philanthropy better than John A. Sobrato



John A. Sobrato

On January 25, 2012, Valley Medical Center Foundation (VMCF) formally accepted the largest gift ever made to the organization in its 24-year history.

On that day, VMCF Board Member John A. Sobrato publicly committed \$5 million in matching grant funds to help furnish Santa Clara Valley Medical Center's (VMC) new 168-bed hospital tower with state-of-the-art rehabilitation and patient care equipment.

"Health care is one of the most important services we avail ourselves of, and VMC does

an excellent job of making sure all residents in this region have access to health care regardless of their ability to pay," says John A. Sobrato. "As the demand for health care increases, I want to make sure VMC is equipped to continue to meet its world-class standards."

In honor of the Sobrato family's generous gift, the 370,000-square foot building currently under construction was dedicated as the John A. and Susan Sobrato Pavilion. The facility will house the Rehabilitation Center, intensive-care and acute-care facilities, private patient rooms, and other important services.

"Offered as a matching opportunity, Mr. Sobrato's gift brings so much to the success of VMC. The \$10 million total that we hope to raise means the difference between opening our new hospital pavilion with outdated equipment, or opening with the latest technologies worthy of our patients," says VMCF Executive Director Chris Wilder.

Mr. Sobrato says his vision for VMC is that the hospital and health care system are able to keep pace with population growth and increasing demands so no resident goes without essential health care. "Silicon Valley can become the healthiest region in the country if more people commit to help build and support great institutions like VMC," he says.

Mr. Sobrato is a long-time supporter of VMC. He joined the VMCF Board of Directors in the early 1990s and has given to VMC on several levels. He proved the value of challenge grants in 2004 when he offered a \$1-million matching gift to complete the Parisi House, a facility to help mothers with young children overcome drug dependencies. Mr. Sobrato collaborated again with the Foundation in 2006 when he offered \$1 million in challenge funds to equip VMC with a world-class linear accelerator machine for cancer radiation treatments. The Sobrato Cancer Center provides premier care to oncology patients at VMC every day.

"When John Sobrato invests in a public benefit corporation like the VMC Foundation, we get more than dollars and cents. We get a stamp of approval from one of the nation's most discerning philanthropists," says Wilder.

While VMC and the Foundation have enjoyed tremendous support from Mr. Sobrato and the Sobrato family, so, too, has the greater Silicon Valley community. Mr. Sobrato is a stalwart believer in serving his community and he has instilled these philanthropic values in his family. "When I was 12 years old, I would watch my mother doing volunteer work at St. Anthony's in Redwood City. It had a big impact," Sobrato recalls. "She was a widow and raising a son, but she found time to keep things in perspective and help those who needed tangible support. I learned that you can always make the time to help someone in need."

Today, Mr. Sobrato is continuing his mother's legacy. Sobrato family members begin their formal education in the business of philanthropy at a young age. They start by attending The Sobrato Family Foundation board meetings as an observer in their teens, learning first-hand the myriad ways to serve the community. "Everyone in our family is engaged in causes we care about. It is part of our DNA. The best way to teach philanthropy is to become a role model through your actions," Sobrato says.



The new John A. and Susan Sobrato Pavilion will open in 2014.



Sobrato and grandson Jeff Sobrato pictured in the lobby of VMC's Sobrato Cancer Center. Like all other services at VMC, the Sobrato Cancer Center will treat all, regardless of ability to pay.



The Sobrato Pavilion will incorporate design features intended to calm patients and visitors, while making navigation easy.



Pictured here in 2008 with the Santa Clara County Board of Supervisors and fellow members of the VMC Foundation Board of Directors, Sobrato made the lead gift for what would become VMC's Sobrato Cancer Center.

Mr. Sobrato and members of his family support numerous Silicon Valley organizations as Board members, and the patriarch himself is a decades-long supporter of institutions such as Bellarmine College Preparatory and Santa Clara University, both alma maters.

"A person like Mr. Sobrato leaves a legacy for people of his ilk to disperse assets in a way that is so constructive on so many levels," says Paul Sheridan, S.J., President of Bellarmine College Preparatory. Father Sheridan credits Mr. Sobrato with inspiring others to make significant commitments to help fund the construction of campus facilities. The Sobrato Center for Humanities and the Arts at Bellarmine College Preparatory opened in 2010.

"His leadership and generosity and interest in education are a legacy that is very much alive in the Valley," says Father Sheridan.

At Santa Clara University, Mr. Sobrato has been a loyal supporter of the university's mission and values for over 50 years. "Mr. Sobrato is a great example of how a Santa Clara University education works. He uses it in his career and he uses it to the benefit of the wider community," says Michael Engh, S.J., President of Santa Clara University. "He exemplifies the Jesuit tradition of 'men and women for others.'"

In 2007, the Sobrato family helped support a major capital campaign led by former SCU President Paul Locatelli, S.J., a longtime friend and former classmate of Mr. Sobrato. The \$20 million gift helped to fund construction of the university's new Learning Commons and Library whose Technology Center bears the Sobrato family name.

Sobrato family members start by attending Sobrato Family Foundation board meetings as an observer in their teens, learning first-hand the myriad ways to serve the community.

"Santa Clara owes Mr. Sobrato tremendous gratitude," says Father Engh. "His impact is very profound. He is an inspiration to other Trustees and friends and benefactors of the university."

Like Bellarmine College Preparatory and Santa Clara University, United Way Silicon Valley (UWSV) has benefited from Mr. Sobrato's support in countless ways. While aiding the greater efforts of UWSV for many years, Mr. Sobrato's philanthropy directly impacted UWSV when it became a tenant at the Sobrato Center for Nonprofits - San Jose. "It's an incredible privilege to be in this building with so many colleagues in the sector," says UWSV President and CEO Carole Leigh Hutton. The Sobrato Center for

Nonprofits is an innovative program of The Sobrato Family Foundation that provides rent-free office space to non-profit organizations in Santa Clara and San Mateo Counties.

Of his role as a director on the UWSV Board, Hutton notes Sobrato's experienced leadership. "John has a laser focus on making things happen," she says. "His success in business is no accident, and it's the same attributes that lead to his success in philanthropy."

John A. Sobrato and his family are deliberate in their commitment to invest solely in local organizations. Sobrato explains why: "There have been four generations of Sobrato's in Silicon Valley and our family has benefitted greatly from the region's growth. We want to directly give back to the communities that helped us achieve our successes, and also support those who live in our communities and who need it the most." ❖



Sobrato and grandson Jeff Sobrato accompany Dr. Tom Bush (far left) and Dr. Eamonn Dunphey as they view VMC's Linear Accelerator, purchased in part with funds from his donation to the Sobrato Cancer Center.

Scan this image using a QR code reading application on your smart phone to see more on the Sobrato donation to VMC.



5 things you should



When the new John A. and Susan Sobrato Center in 2014, it will be one of the most modern. And for good reason – as the largest and busiest – ready to meet the increasingly complex

Improved efficiency

The Sobrato Pavilion will be replacing facilities that are over 50 years old. Obviously, hospital care has changed dramatically since that time. The new building will help VMC continue to treat more patients at reduced cost, saving staff time and improving the patient experience.

The Sobrato Pavilion will feature private rooms for all patients. While the benefit for patients is clear, private rooms also allow for improved hospital operations.



Single patient rooms and flexible nursing stations means patients will have greater privacy and attention in the new Sobrato Pavilion.



It's also a lot safer. Multi-patient rooms require extra attention towards infection control and privacy issues. That takes staff time – and money – that would be better spent on direct patient care.

Flexible nursing stations will allow staff to monitor all patients from anywhere in the unit, while providing work space closest to the highest need patients.

A model for environmental sustainability

When complete, the Sobrato Pavilion will be a model for environmental sustainability for hospitals worldwide. The facility is on track to become one of the first hospital facilities in the United States to achieve LEED Gold certification by the U.S. Green Building Council.

The building will take advantage of two solar panel systems that will generate 10% of the campus energy needs. Exterior walls are designed to minimize heat loss and gain, three green-roof areas will help regulate temperature and reduce storm water run-off. Inside, low VOC (volatile organic compounds) construction materials, sustainably harvested wood, water-efficient plumbing fixtures and an abundance of natural light will minimize indoor air pollution, water and energy usage. These steps and others will save VMC nearly \$500,000 in annual energy costs.



Solar panels already installed on two VMC parking garages will supply 10% of campus-wide energy needs.

Know about the Sobrato Pavilion

Pavilion opens at Santa Clara Valley Medical Center, one of the most modern hospital facilities in the United States. As the oldest hospital in Silicon Valley, VMC must be able to meet the healthcare needs of this community.

A healing environment for patients, visitors and staff

If you walk the hallways of the 1960's era Valley Medical Center, you enter an environment where the patient experience seems – at best - an afterthought. Sterile walls and dimly lit hallways and rooms harkens back to another era of American healthcare.

The new Sobrato Pavilion charts a radically new path, where the patient experience is at the center. All patient rooms will be equipped with massive windows, private bathrooms and soothing lighting. Natural materials and colors will help create a calming environment. And that's critical. It takes more than great doctors and nurses to make a



An atrium will link the lobbies between the current Main Hospital and Sobrato Pavilion, providing a calming place for visitors and staff to relax and reflect.

patient well – it takes a patient who is calm, relaxed and actively part of the healing process.

Communal spaces like a meditation room and atrium will provide similar relief for patients' families and friends.



VMC rehab patient Katie Sharify is one of only five people to receive stem cell treatments for her spinal cord injury, as part of VMC's clinical trial. The rehab center will move to the Sobrato Pavillion in 2014, continuing a 40-year history of excellence.

A new Rehabilitation Center

Among the many important units and services that the Sobrato Pavilion will house, none are better known than VMC's nationally recognized Spinal Cord and Traumatic Brain Injury Rehabilitation Center. The new building will finally provide the Rehab Center with a facility that matches the quality of the program. New gyms, a therapy pool, outdoor terrain park, family and community spaces and private patient rooms will provide patients and families with the best possible rehabilitation care.

It will also allow the Rehab Center to continue its tradition of integrating research with front-line patient care, with more space to test new equipment and technologies.

You can make a difference

While public funds provided by Measure A will fund the construction of the building, additional resources are needed to outfit the building with critical equipment and technology. With the leadership of John A. and Susan Sobrato, the VMC Foundation has launched a campaign to raise \$10 million in support of the new facility. Join others who have already given.

Valley Foundation: \$200,000 to support the Rehab Center's Independence Plaza

Sovereign Order of St. John of Jerusalem,

Knights Hospitaller: \$100,000 to support Independence Plaza

SCVMC Volunteer Auxiliary: \$100,000 to support high-end equipment needs

No hospital cares for more people in this community than VMC. A gift to support the Sobrato Pavilion Matching Gift Campaign will be sure to have a lasting impact. To learn more, please contact Chris Wilder, Executive Director, at 408-885-5299, or visit www.vmcfoundation.org.



John A. Sobrato and VMC Foundation Executive Director Chris Wilder announcing the Sobrato Pavilion gift.



State Assembly member Jim Beall speaks at the groundbreaking for the Sobrato Pavilion in September 2009. As a former Santa Clara County Supervisor, Beall was an early and vocal supporter of Measure A.

A vote for VMC

The story of the Sobrato Pavilion that almost never was

The future of Santa Clara Valley Medical Center changed at 4:31 on a cool January morning in 1994 when the earth shook thousands of people from their slumber half a state away.

The 1994 Northridge earthquake registered 6.7 on the Richter scale, injuring more than 9,000 people and rendering 12 Los Angeles-area hospitals as unsafe for occupancy. As a result, the State of California enacted seismic safety laws mandating that by 2014 all hospital buildings in California would be seismically compliant to sustain a magnitude 8.0 earthquake. By 2030, these same buildings must remain fully operational in the event of a major temblor. As with all hospitals, Santa Clara Valley Medical Center (VMC) was responsible for securing its own funding to fulfill the requirements of SB 1953.

VMC's Seismic Safety Project would comprise Phases I and II and nearly 20 years of planning, design, and construction. Financial figures in early 2008 showed a severe shortage of funds to complete the necessary seismic upgrades. Without public support, VMC was at risk of losing more than half of its hospital beds and critical services such as the Trauma Center and the Burn Center.

Robin Roche, chair of the Valley Medical Center Foundation Board of Directors and former executive director of VMC, recalls intense com-

mittee meetings to determine VMC's priorities in meeting the State's stringent requirements for seismic upgrades. He also speaks of meeting with the Santa Clara County Board of Supervisors in early 2008 to get approval to ask taxpayers in the upcoming November election to help fund the Seismic Safety Project by means of a bond. "We had a compelling case. VMC is a public hospital that is there for everybody. We are all very fortunate to have it. VMC provides services that are important to all of Northern California," Roche said.

California State Assembly Member Jim Beall, who was a Santa Clara County Supervisor in 2006, believed in VMC's cause. "Supporting Measure A was easy. It made sense. We all understood the critical importance of keeping the largest receiving hospital in Santa Clara County open and running in the event of a catastrophe. Valley Medical Center is crucial to the welfare of Northern California because it is the most comprehensive hospital in the region," Beall said. VMC is just one of two hospitals in Santa Clara County with Level One trauma centers for adult and pediatric care, the only federally-recognized spinal cord injury rehabilitation center in the region, and one of the most highly regarded burn trauma centers in the state.

Chris Wilder, executive director of the Valley Medical Center Foundation (VMCF), served with Roche on the Seismic Safety Committee. With the County Board of Supervisors endorsing the bond, Measure A became Wilder's crusade. He chaired the campaign in his personal time, rallying thousands of people in support of investing in a county hospital. In April 2008, just six months shy of the election, a public opinion poll showed

that Measure A was likely to fail. The economy was suffering and the measure was asking property owners to approve a parcel tax with 2/3 vote. The study also revealed that most people polled knew very little about VMC.

When others may have viewed the statistics as a dismal sign, Wilder says the results gave the committee hope. "It was an opportunity to educate the public that VMC has the top trauma center in San Jose, the only burn-trauma center in the San Francisco Bay Area, and a state-of-the-art traumatic brain injury and spinal cord injury rehabilitation center," Wilder said. And to those who claimed in reference to VMC, "That's the hospital that takes care of poor people," Wilder's response then and to this day is, "That's the hospital that takes care of everybody. You or someone you love will need VMC." Research shows that 1 in 4 people in the community use VMC at some point for medical care or services.



Construction on the Sobrato Pavilion started just a few months after the passage of Measure A in November 2008, a significant feat given the complexity of the building.

Neighboring hospitals also rely heavily on VMC and saw the need to support the hospital through campaign contributions to Measure A. "VMC is a powerhouse in the community. We got a lot of support from the medical community and local hospitals," Roche said. Among the earliest supporters of Measure A was El Camino Hospital.

"VMC is critical to the delivery of healthcare in this county. In many cases, they are the only resource available for some community members," said Barbara Avery, director of community benefit at El Camino Hospital. "VMC and El Camino Hospital work together to improve access to medical care in many ways."

Measure A garnered support, too, from Santa Clara County nonprofit organizations such as Working Partnerships. Sarah Muller was director of health policy at Working Partnerships during the campaign. She recalls that one of the greatest challenges of Measure A was getting the community to understand the value of VMC. A key message for Muller was to highlight the critical resource that VMC is for Santa Clara County. "VMC offers services you can't find anywhere else [in the region], no

matter who you are or what kind of health insurance you have." Muller, now with the California Association of Public Hospitals and Health Systems, believes that Measure A will have even greater impact on the community with healthcare reform on the horizon. "VMC is poised to be a leader in Santa Clara County to help ensure the success of healthcare reform," she said. "There is going to be a great need for VMC under healthcare reform post-2014."

Measure A won support with an overwhelming margin on Election Day 2008. "The voters said yes beyond our wildest expectations. We got more votes in Santa Clara County than Barack Obama," said Wilder. "In a time of fiscal crisis, people stepped up because they truly understood the need."

Roche fondly remembers the victory. "It's one of the best things I've been involved with in my career. It was like the community gave us a big hug," he said.

With the passage of Measure A, which asked taxpayers for \$840 million, Santa Clara County voters ensured that their public hospital would be built to the highest standards in health care, technology, construction, and design.

Standing 6-stories tall, the 370,000-square foot building, dedicated as the John A. and Susan Sobrato Pavilion, will house 168 private hospital beds for ICU and acute-care patients; the lauded Rehabilitation Center for traumatic brain injury, stroke, and spinal cord injury patients; Independence Plaza; and other important patient services.

Architect Peter Schlosser spent 20 years of his career designing the three largest buildings on the hospital's campus, including early work on the Sobrato Pavilion. "All of these buildings, when viewed collectively, evoke a brand identity for VMC and the Santa Clara Health and Hospital System," said Schlosser.

Beyond structural mandates for seismic compliance and design aesthetics, Schlosser notes that flexibility and long-term adaptability were important to the design of the new VMC. "Optimum design anticipates future operational

Research shows that 1 in 4 people in the community use VMC at some point for medical care or services.

Continued on Page 11

Thanks to a strong coalition of community, labor, faith, small business and healthcare leaders, Santa Clara County voters heard early and often from the Yes on Measure A campaign. Over 78% of voters approved the measure.

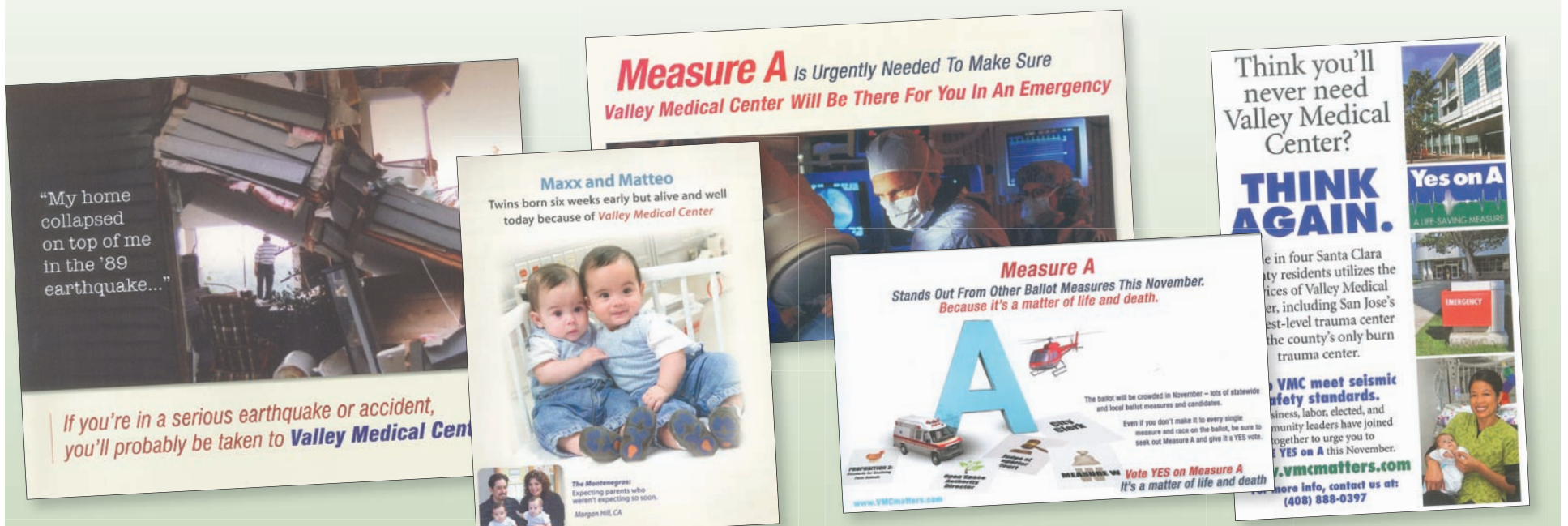



Left and below: Independence Plaza provides a place for rehab patients to practice their therapy in a calming, outdoor setting. The plaza includes a terrain park that mimics that variety of surfaces that a patient will navigate in the outside world, from stairs to street curbs and dirt roads.

A new day for VMC Rehab

VMC's renowned Rehabilitation Center will find a new home in the Sobrato Pavilion and seeks a major sponsor



For the past 40 years, VMC's renowned Spinal Cord and Traumatic Brain Injury Rehabilitation Center has helped thousands of patients following catastrophic illness and injury. In the process, it became a national model for rehabilitation, and pioneered groundbreaking therapies and treatment.

But what it has never had – especially of late – is a facility that matches the quality of the people and care. With the new Sobrato Pavilion, that's all about to change.

Beginning in 2014, the Rehab Center will occupy over two floors of the new facility. It will mark a significant turning point in the history of the program.

"Finally, after 40 years, VMC will have a building that matches the quality of our rehab program," said Chris Wilder, VMC Foundation executive director.

While the current center scores high marks with patients, its size and outdated design can sometimes be a hindrance. No more so than with the patient rooms, which at the current facility are all multiple occupancy. The new center will not only offer private patient rooms and bathrooms, but also plenty of space for families to stay and even sleep over.



Scan this image using a QR code reading application on your smart phone to see a video of Katie Sharify, a recent VMC Rehab patient.

"People stay in rehab for a long time," said Ann Perkins, director of Rehab Relations at VMC. "Family involvement is key. Having comfortable, private space for family to be with the patient in their own room will be a real asset."



Aquatic therapy is an important part of the rehab program at VMC. The new pool will include large windows viewing the exterior Independence Plaza.

The interior of the center is designed to incorporate soothing, natural colors and natural light. The idea is for every aspect of the design to help put the patient at ease. A new aquatic therapy center will overlook outdoor gardens, and numerous spaces will exist for community gatherings, peer support and family visits.

"Rehab is a very intense process," said Perkins. "Staff has to work hard to psychologically motivate people to do the work and get better. Being in this nice environment will help with that motivation."

Private rooms won't be the only benefit to patients. A new outdoor terrain park, Independence Plaza, will offer patients a scenic and relaxing venue to practice their therapy in real-world conditions. From learning to

use a wheelchair on gravel to navigating curbs and cobblestone on crutches, Independence Plaza is designed to mimic a variety of surfaces that patients will need to overcome once they leave rehab.

Just as important, being outside offers patients a chance to break from their routine and enjoy the sunshine. The psychological lift can be important.

"When I talk to our former rehab patients, they always tell me how much they enjoy VMC's emphasis on getting out and doing things," said Wilder. "Being in a hospital can be depressing. Places like Independence Plaza make it less so – at times even fun and joyful."

The new facility comes at an exciting time for VMC Rehab. In the past year, VMC became one of the first centers in the nation to test bionic exoskeletons to help paralyzed patients walk again, and took part in the first trial of embryonic stem cells to treat spinal cord injuries.

"It's a very exciting time at VMC," said Wilder.

While the new center will be housed in the Sobrato Pavilion, the VMC Foundation is still seeking naming rights donors to help fund equipment and technology purchases for the new rehabilitation center.

"This is a very unique opportunity to have your name on one of the finest rehab centers in the world," said Wilder. ♦



Two floors of the Sobrato Pavilion will be dedicated to VMC's Rehab Center.

A VOTE FOR VMC Continued from Page 9

and programmatic needs," said Schlosser. VMC's new buildings include such design innovations as mechanical and zoning systems that allow for spot remodeling without impeding the entire facility, a sophisticated telecommunications infrastructure to adapt to future technology, and modular strategies that enable change-of-use with minimum changes to physical infrastructure.

"The inspiration was to create a modern aesthetic that speaks to the quality of care one would expect to receive in Silicon Valley while also creating buildings that are timeless," Schlosser said. "These buildings are designed with the idea of having a very long service life by using durable and maintainable materials that can stand the test of time."

The new VMC is designed to meet LEED Gold certification in green building and design as outlined by the U.S. Green Building Council. Among the improvements are eco-technologies that are expected to save VMC \$500,000 annually in energy costs.

Overseeing the Seismic Safety Project is Linda Mowry, director of seismic compliance and modernization projects at VMC. Mindful of Measure A's role in securing funds to complete the required seismic upgrades, Mowry acknowledges, "We have an added fiduciary responsibility to return the taxpayer support of VMC with a building where they can receive the quality of care they expect in an environment that supports their wellbeing and promotes their health."

She also considers the hospital's practical needs for administering quality patient care. "While seismic safety is the crux of the Sobrato Pavilion's construction, patient and staff needs informed the building plan, layouts, and design. Patients are the priority and their care requirements, comfort, and safety drove the quality and decision-making behind the physical environment," Mowry said. The Sobrato Pavilion will feature all single-patient rooms with in-ceiling patient lifts, ADA bathrooms, and adequate space for providing bedside care, as well as cost-effective systems to increase staff efficiencies and employee satisfaction.

Hospital CEO Linda Smith echoes Mowry's enthusiasm for technical efficiencies of the new VMC. "As exciting as the new building is, so, too, is the new electronic medical record. It's just as transformative," she says. "We'll have more complete information on the patients we serve, when we serve them. It makes us all more efficient."

With sights on the future of healthcare in Silicon Valley, Smith added, "We are the place to go for specialty care. VMC is a center for excellence."

The John A. and Susan Sobrato Pavilion, the final project in a trilogy of facilities comprising the new VMC, is scheduled for completion in 2014. ♦

Scan this image using a QR code reading application on your smart phone to see more about the Sobrato Pavilion.





Building Community Together

FOCUS

Business Bank

10 Almaden Blvd., Suite 150 San Jose, California 95113
800.742.8142 www.FocusBusinessBank.com

“We are so impressed with Focus Banking's creative thinking and how they have assisted in streamlining our processes. Without being asked, they contact us with ideas to save time and money. How can you ask for more than that!”

*—Chris Wilder
Executive Director
VMC Foundation*

the VMC
foundation

Helping Silicon Valley Care

